

WOOD AND CUTS FOR LIGHTWEIGHT FERAL CAT SHELTER

Design adapted from Alley Cat Allies by
Cat Assistance Team of Central Ohio (www.catteam.org)

Each shelter uses one 4' x 8' Sheet of 1/4" Plywood

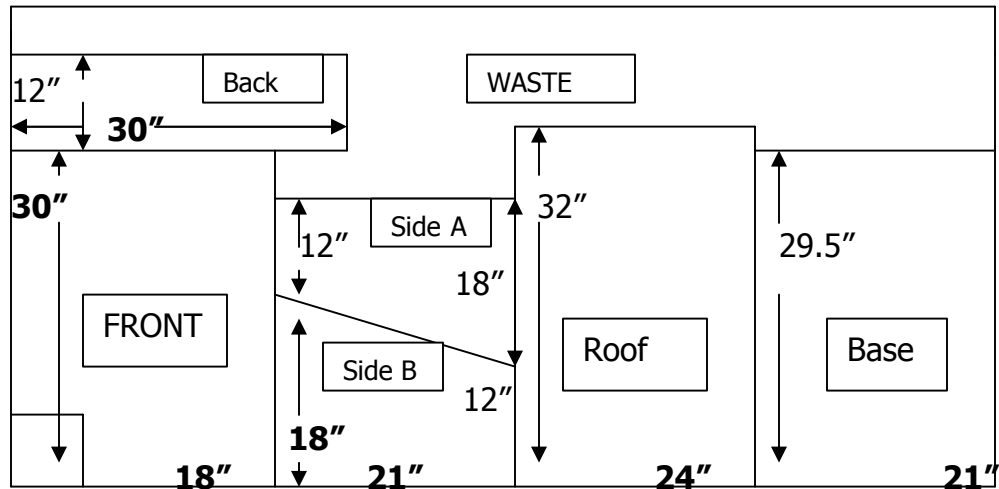

Note: cutout on front panel is 8" high x 6" wide for door
Note: this diagram is not to scale!

THREE PINE PIECES (8' lengths)

8' x 1" x 1 1/2"

- First piece: Cut three 28" lengths and one 9 3/4" length
- Second piece: Cut two 27" lengths and one 21" length
- Third piece: Cut one 21" length, two 15 1/4" lengths and one 9 3/4" length